



TSUMEB MUNICIPALITY

# Request for Quotations for Works

*Construction of three (3) additional offices at the Tsumeb Municipality Head  
Office Building*

---

**Procurement Reference No: W/RFQ/TSBMUN-01/2024/25**

Name of Bidder	:	_____
Contact Person	:	_____
E-mail Address	:	_____
Postal Address	:	_____
Bid Amount (incl. VAT)	:	_____
Contact Number	:	_____

**Documents must be submitted in:**

**The Quotation/Bid Box**

**Att:** Procurement Management Unit (PMU)

Tsumeb Municipality

Erf 264, Moses Garoeb Street

P/Bag 2012, Tsumeb

**Closing Date: Tuesday, 06 August 2024 at 11h00**

**Non-compulsory Pre-Bid Meeting: 24 July 2024 at 11h00 – Tsumeb Municipality Head Office**

**LATE BIDS WILL NOT BE ACCEPTED!**



---

## TSUMEB MUNICIPALITY

---

Tel: +264(0)67221056/7/8  
Fax: +264(0)67221464/2210667

Private Bag 2012  
Tsumeb  
Namibia

### Letter of Invitation

**Name and Address of Bidder:** \_\_\_\_\_  
\_\_\_\_\_

**Procurement Reference Number: W/RFQ/TSBMUN-01/2024/25**

**11 July 2024**

Dear Bidder,

**Request for Quotations for the Construction of three (3) additional offices at the Tsumeb Municipality Head Office Building**

The *Tsumeb Municipality* invites you to submit your best quote for the works described in detail hereunder.

Any resulting contract shall be subject to the terms and conditions referred to in the document.

Queries, if any, should be addressed to the **Procurement Management Unit (PMU)**, *Email:* [procurement@tsumebmun.org.na](mailto:procurement@tsumebmun.org.na)

Please prepare and submit your quotation in accordance with the instructions given or inform the undersigned if you will not be submitting a quotation.

Yours faithfully,

A handwritten signature in black ink, appearing to read 'Toivo Shipanga'.

**Mr. Toivo Shipanga**  
**Head: Procurement Management Unit (PMU)**

## **SECTION I: INSTRUCTIONS TO BIDDERS**

### **1. Rights of Public Entity**

The *Tsumeb Municipality* reserves the right:

- (a) to split the contract as per the lowest evaluated cost per lot; and
- (b) to accept or reject any quotation or to cancel the quotation process and reject all quotations at any time prior to contract award.

### **2. Preparation of Quotations**

You are requested to quote for the works mentioned in Section III, by completing, signing and returning:

- (a) the Quotation Letter in Section II with its annex for Bid Securing Declaration, where applicable;
- (b) the Priced Activity Schedule in Section IV;
- (c) the Specifications and Compliance Sheet in Section V; and
- (d) any other attachment as deemed appropriate

You are advised to carefully read the complete Request for Quotations document, including the Special Conditions of Contract in Section VII, before preparing your Quotation. The standard forms in this document may be retyped for completion but the Bidder is responsible for their accurate reproduction.

### **3. Validity of Quotations**

The quotation validity period shall be **90** days from the date of bid submission deadline.

### **4. Eligibility Criteria**

To be eligible to participate in this Quotation exercise, you should:

- (a) a valid certificate of good standing with the Receiver of Revenue;
- (b) a valid certificate of good standing with the Social Security Commission or, in the case where
- (c) a company has no employees, a confirmation letter from the Social Security Commission;
- (d) as required by the Affirmative Action (Employment) Act 1998 (Act no. 29 of 1998) –
  - (i) a valid affirmative action compliance certificate issued under section 41 of that Act;
  - (ii) an exemption issued under section 42 of that Act; or
  - (iii) a proof from the Employment Equity Commission that the bidder or the supplier is not a relevant employer as defined in that Act
- (e) a written undertaking as contemplated in section 138(2) of the Labour Act, 2007 (Act No. 11 of 2007); and
- (f) a valid –

- (i) certificate of business registration for an entity incorporated or registered under the company or close corporation laws of Namibia;
- (ii) certificate of registration of a co-operative registered under the laws regulating co-operatives in Namibia
- (iii) document serving as evidence of registration as a trust and the trust deed for a trust registered under laws regulating trusts in Namibia; or
- (iv) partnership agreement in the case of a partnership, a valid joint venture agreement in the case of a joint venture or a valid agreement in case of other similar agreements, but a bidder or supplier who is a sole proprietor only needs to comply with the provisions of (a) to (d)
- (g) have a certificate indicating SME Status (for Bids reserved for SMEs);
- (h) Submit signed Bid-securing Declaration.

**Documents are accepted as follows:**

- (a) A valid original document;
- (b) A valid certified copy of an original document, as certified by a Commissioner of Oath appointed in terms of the Justices of the Peace and Commissioners of Oaths Act, 1963 (Act No. 16 of 1963) as amended; or
- (c) A printout of a valid electronic or online document issued in terms of the Electronic Transaction Act, 2019 (Act No. 4 of 2019), subject to the authentication or validation of such printout by a public entity during the bid evaluation process, in accordance with the authentication or validation guidelines of the issuing authority.

**5. Bid Security/Bid Securing Declaration**

Bidders are required to subscribe to a Bid Securing Declaration for this procurement process.

**6. Works Completion Period**

The completion period for works shall be *2 Months* after acceptance and issue of Purchase Order. Deviation in completion period shall be considered if such deviation is reasonable.

**7. Sealing and Marking of Quotations**

Quotations should be sealed in a single envelope, clearly marked with the Procurement Reference Number, addressed to the Public Entity with the Bidder's name at the back of the envelope.

**8. Submission of Quotations**

Quotations should be deposited in the Quotation/Bid Box located at ***Municipal Head Offices, Erf 264, Moses Garoeb Street, Tsumeb***, not later than ***Tuesday, 06 August 2024 at 11h00***. Quotations by post or hand delivered should reach *the same address* by the same date and time at latest. **Late quotations will be rejected.**

**Quotations received by e-mail will not be considered.**

## 9. Opening of Quotations

Quotations will be opened internally by the Public Entity immediately after the closing time referred to in section 8 above. A record of the Quotation Opening stating the name of the bidders, the amount quoted, the presence or absence of a Bid Security/Bid Securing Declaration, will be posted on the Tsumeb Municipality website: [www.tsumebmun.org.na](http://www.tsumebmun.org.na) and available to any bidder on request within three working days of the Opening.

## 10. Evaluation of Quotations

The Public Entity shall have the right to request for clarifications in writing during evaluation. Offers that are substantially responsive shall be compared on the basis of evaluated cost, subject to Margin of Preference where applicable, to determine the lowest evaluated quotation.

### 10.1. Technical Evaluation

No.	Description of Technical Evaluation Criteria	Requirement	Score	Total
1.	General experience in Construction (Buildings and Renovations) in the last 5 years  <b>Note: Proof thereof should be stated in the provided letters or completion certificates with contactable references</b>	>= N\$ 600,000.00/5Yrs	40	40
		N\$ 400,000.00 – N\$ 599,999.00/5Yrs	30	
		N\$ 300,000.00 – N\$ 399,999.00/5Yrs	20	
		< N\$ 300,000.00/5Yrs	0	
2.	Work Delivery Schedule	Detailed work delivery schedule/program	10	10
		Generalized work delivery schedule/program	5	
		No work delivery schedule or program	0	
3.	Personel: Submit CV for <b>Civil Artisan</b> with a minimum of an N3 certificate with Experience in Building Construction and Renovations	>5 years of work experience	20	20
		4-5 years of work experience	10	
		2-3 years of work experience	5	
		<2 years of work experience	0	
4.	Company profile (detail of experience, references, business address and insight to activities)	Detailed company profile indicating the following <ul style="list-style-type: none"> <li>• Business address</li> <li>• Demographics (number of employees)</li> <li>• Geography (operational coverage)</li> <li>• Office space</li> </ul>	10	10
		Company profile not clearly narrated	5	
		No profile	0	
5.	Attendance of site or pre-bid meeting	The bidder attended the site/pre-bid meeting	10	10
		The bidder did not attend the site/pre-bid meeting	0	

6.	Experience in occupational health, safety, and environmental management	HSE policy/plan attached	10	10
		No HSE policy/plan attached	0	
TOTAL				100

The total Qualification criteria score is out of 100% marks. Only bidders with a minimum of 70% marks score for the Technical Qualification criteria will proceed to the Financial Evaluation

### 10.2. Financial Evaluation

- Any unsustainably low and unaffordable high Bid, i.e., any Bid with a total Bid Price (after arithmetically corrected) below -15% and any Bid with a total Bid Price (after arithmetically corrected) above +15%, calculated from the Employer estimate, **shall be disqualified**.
- Bidders will be ranked in descending order. The bidder ranked 1 will be deemed most responsive and awarded the contract.

## 11. Technical Compliance

The Specifications and Compliance Sheet details the minimum specifications of the works to be carried out. The specifications have to be met, but no credit will be given for exceeding the specifications.

## 12. Prices and Currency of Payment

Prices for the execution of works shall be fixed in Namibian Dollars as quoted. Quotations shall cover all costs of labour, materials, equipment, overheads, profits and all associated costs for performing the works, and shall include all duties. The whole cost of performing the works shall be included in the items stated, and the cost of any incidental works shall be deemed to be included in the prices quoted.

## 13. Margin of Preference

13.1. The applicable margins of preference and their application methodology are as follows:

- Code of good practice on preferences referred to in sections 71 and 72 of the Public Procurement Act, 2015, *Exclusive Preference for Local Suppliers*

13.2. Bidders applying for the Margin of Preference **should submit** the below evidence as required:

CATEGORIES OF BIDDERS	MARGIN OF PREFERENCE	DOCUMENT EVIDENCE TO BE SUBMITTED
Manufacturer	2%	<ul style="list-style-type: none"> <li>✓ Certificate of registration from a registering authority.</li> <li>✓ Declaration by the bidder that the manufactured goods meet the local content as determined in Annexure 6 as per the cost structure for Valued Added Calculation in Schedule 2, and as certified by an Accountant.</li> </ul>
Micro, Small and Medium Enterprise	1%	<ul style="list-style-type: none"> <li>✓ SME registration certificate</li> <li>✓ Declaration indicating the percentage of Namibian MSME ownership</li> </ul>
Women owned enterprise	1%	<ul style="list-style-type: none"> <li>✓ IDs of all shareholders</li> <li>✓ Founding statement/company registration indicating ownership structure/shareholder certificate</li> <li>✓ declaration indicating the percentage of Namibian female ownership</li> </ul>

<b>Youth Owned enterprise</b>	2%	✓ IDs of all shareholders ✓ Founding statement/company registration indicating ownership structure/shareholder certificate ✓ declaration indicating the percentage of Namibian youth ownership.
<b>Previously Disadvantaged person owned enterprise</b>	2%	✓ IDs of all shareholders ✓ Founding statement/company registration indicating ownership structure/shareholder certificates ✓ declaration indicating the percentage of Namibian PDPs ownership.
<b>Suppliers providing environmental protection</b>	1%	✓ Declaration and proof that the bidder meets the requirements set out in the bidding document.
<b>Suppliers providing employment to Namibian</b>	1%	✓ declaration that the bidder employs 50% or more Namibian citizens.
<b>TOTAL</b>	<b>10%</b>	

**The margin of Preference will be applied as per the formula below:**

$$\frac{A = MP \times BP}{100} \text{ in which the formula}$$

- “A” represents the amount to be determined:
- “MP” represents the total percentage of all margins of preferences granted in respect and
- “BP” represents the bid price.

#### **14. Award of Contract**

The Bidder having submitted the lowest evaluated responsive quotation and qualified to perform the works shall be selected for award of contract. Award of contract shall be by issue of a Purchase Order/Letter of Acceptance in accordance with terms and conditions contained in Section VI: Contract Agreement and General Conditions of Contract.

#### **15. Notification of Award and Debriefing**

The Public Entity shall after award of contract promptly inform all unsuccessful bidders in writing of the name and address of the successful bidder and the contract amount and post a notice of award on its website within 7 days. Furthermore, the Public Entity shall attend to all requests for debriefing made in writing within 7 days of the unsuccessful bidders being informed of the award.

## SECTION II: QUOTATION LETTER

(to be completed by Bidders)

*[Complete this form with all the requested details and submit it as the first page of your quotation with the Priced Activity Schedule and documents requested above. A signature and authorisation on this form will confirm that the terms and conditions of the RFQ prevail over any attachments. **If your quotation is not authorised, it will be rejected***

<b>Quotation addressed to:</b>	<b>Tsumeb Municipality</b>
<b>Procurement Reference Number:</b>	<b>W/RFQ/TSBMUN-01/2024/25</b>
<b>Subject matter of Procurement:</b>	<b>Construction of three (3) additional offices at the Tsumeb Municipality Head Office Building</b>

We offer to execute the Works detailed in the Statement of Requirements, in accordance with the terms and conditions stated in your Request for Sealed Quotations referenced above.

We confirm that we are eligible to participate in this Quotation exercise and meet the eligibility criteria specified in Section 1: Instructions to Bidders

We undertake to abide by the Conduct of Bidders and Suppliers as provided under the Public Procurement Act during the procurement process and the execution of any resulting contract.

We have read and understood the content of the Bid Security/Bid Securing Declaration (BSD) attached hereto and subscribe fully to the terms and conditions contained therein. We further understand that this subscription could lead *[forfeiture of the security amount / disqualification on the grounds mentioned in the BDS]*

The validity period of our Quotation is \_\_\_\_\_ days *[insert number of days]* from the date of the bid submission deadline.

We confirm that the prices quoted in the Priced Activity Schedule are fixed and firm and will not be subject to revision or variation, if we are awarded the contract **prior to the expiry** date of the quotation validity.

Works will commence within \_\_\_\_\_ *[insert number]* days from date of issue of Purchase Order/ Letter of Acceptance.

Works will be completed within \_\_\_\_\_ *[insert number]* days from date of issue of Purchase Order/ Letter of acceptance.

### Quotation Authorised by:

Name of Bidder		Company's Address and seal	
Contact Person			
Name of Person Authorising the Quotation:		Position:	Signature:
Date		Phone No./E-mail	



## Appendix to Quotation Letter

**BID SECURING DECLARATION**  
**(Section 45 of Act)**  
**(Regulation 37(1) (b) and 37(5))**

**Date:** *[Day | month | year]* .....

**Procurement Ref No.:** .....

**To: Tsumeb Municipality, Erf 264, Moses Garoeb Street, Tsumeb**

I/We\* understand that in terms of section 45 of the Act a public entity must include in the bidding document the requirement for a declaration as an alternative form of bid security.

I/We\* accept that under section 45 of the Act, I/we\* may be suspended or disqualified in the event of

- (a) a modification or withdrawal of a bid after the deadline for submission of bids during the period of validity;**
- (b) refusal by a bidder to accept a correction of an error appearing on the face of a bid;**
- (c) failure to sign a procurement contract in accordance with the terms and conditions set forth in the bidding document, should I/We\* be successful bidder; or**
- (d) failure to provide security for the performance of the procurement contract if required to do so by the bidding document.**

I/We\* understand this bid securing declaration ceases to be valid if I am/We are\* not the successful Bidder

Signed: .....  
*[insert signature of person whose name and capacity are shown]*

Capacity of:  
*[indicate legal capacity of person(s) signing the Bid Securing Declaration]*

Name: .....  
*[insert complete name of person signing the Bid Securing Declaration]*

Duly authorized to sign the bid for and on behalf of: *[insert complete name of Bidder]*

Dated on \_\_\_\_\_ day of \_\_\_\_\_  
*[insert date of signing]*

Corporate Seal (where appropriate)

*[Note\*: In case of a joint venture, the bid securing declaration must be in the name of all partners to the joint venture that submits the bid.]*



## Republic of Namibia

### Ministry of Labour, Industrial Relations and Employment Creation

**Witten undertaking in terms of section 138 of the Labour Act, 2015 and section 50(2)(D) of the Public Procurement Act, 2015**

#### 1. EMPLOYERS DETAILS

Company Trade Name:.....

Registration Number :.....

Vat Number: .....

Industry/Sector: .....

Place of Business:.....

Physical Address:.....

Tell No.:.....

Fax No.:.....

Email Address:.....

Postal Address:.....

Full name of Owner/Accounting Officer:.....

.....

Email Address:.....

#### 2. PROCUREMENT DETAILS

Procurement Reference No.:.....

Procurement Description: .....

.....

.....

Anticipated Contract Duration: .....

Location where work will be done, good/services will be delivered: .....

.....

### 3. UNDERTAKING

I .....[insert full name], owner/representative

of .....[insert full name of company]

hereby undertake in writing that my company will at all relevant times comply fully with the relevant provisions of the Labour Act and the Terms and Conditions of Collective Agreements as applicable.

I am fully aware that failure to abide to such shall lead to the action as stipulated in section 138 of the labour Act, 2007, which include but not limited to the cancellation of the contract/licence/grant/permit or concession.

**Signature:** .....

**Date:** .....

**Seal:**.....

*Please take note:*

1. *A labour inspector may conduct unannounced inspections to assess the level of compliance*
2. *This undertaking must be displayed at the workplace where it will be readily accessible and visible by the employees rendering service(s) in relations to the goods and services being procured under this contract.*

## **SECTION III: STATEMENT OF REQUIREMENTS**

### **Scope of work for the construction of three (3) additional offices at the Tsumeb Municipality Head Office building**

1. Design and Planning:
  - The office layout and structural plans are as per the attached drawings
2. Construction:
  - Excavate and prepare foundations.
  - Erect walls, install roofing, and complete interior finishing.
  - Connect utilities and ensure compliance with building codes.
3. Completion:
  - Conduct inspections and tests for safety and functionality.
  - Hand over completed offices with all documentation and warranties.

## SECTION IV: PRICED ACTIVITY SCHEDULE

Procurement Reference Number: \_\_\_\_\_

*[Complete the unit and total prices for each item listed below. Authorise the prices quoted in the signature block below.]*  
*The quantities shown below are approximate and not subject to re-measurement for payment purposes.*

	MATERIALS				
Item	Description	Unit	Qty	Rate (N\$)	Amount (N\$)
1	<b>PRELIMINARY AND GENERAL ITEMS</b>				
1.1	Site establishment	None		-	-
1.2	Contractors Obligations	Lump sum			
1.3	Time Related	None		-	-
1.4	Supply and erection of project name board	None		-	-
	<b>Total Carried to summary</b>				
Item	Description	Unit	Qty	Rate (N\$)	Amount (N\$)
2	<b>EXCAVATION, FILLING &amp; SOIL POISONING</b>				
2.1	foundation excavations	m3	31.94		
2.2	Termite poison to bottom and sides of foundation trenches	m2	49.14		
2.3	Termite poison under floor	m2	63.14		
2.4	Earth backfilling with suitable and compacted material under surface bed	m3	15.78		
	<b>Total Carried to summary</b>				
Item	Description	Unit	Qty	Rate (N\$)	Amount (N\$)
3	<b>CONCRETE WORKS</b>				
3.1	20 Mpa /19mm Concrete in foundation	m3	12.28		
3.2	Concrete in surface bed	m3	6.31		
3.3	Concrete lintels as per the SABS Standards	m	15.00		
	<b>Total Carried to summary</b>				

Item	Description	Unit	Qty	Rate (N\$)	Amount (N\$)
4	<b>BRICKWORK, PLASTERING &amp; WATERPROOFING</b>				
4.1	Foundation brick wall in class 14MPa cement brick in 1:4 cement mortar brick force elsewhere	Item	5265		
4.2	brick wall in class 14MPa cement brick in 1:4 cement mortar brick force every third layer	Item	18562		
4.3	150mm brick force in double brick wall	m	890		
4.4	Dampcourse 225mm*40m 250mic	m	70.20		
4.5	Cement for plaster (50kg OHORONGO 32.5)	Item	18.00		
4.6	Cement for foundation (50kg 42.5N)	Item	12.00		
4.7	Cement for floor slab (50kg 42.5N)	Item	18.00		
4.8	Building sand	m3	30.00		
4.9	Concret stones (19mm)	m3	10.00		
	<b>Total Carried to summary</b>				
Item	Description	Unit	Qty	Rate (N\$)	Amount (N\$)
5	<b>PAINT AND TILLING WORKS</b>				
5.1	One primer coat and two coats approved acrylic emulsion paint on plastered internal and external wall	m2	161.12		
5.2	One final coat and two coats approved acrylic emulsion paint on plastered internal and external wall	m2	322.24		
5.3	Two coats plascon polvin super acrylic pva paint of 0.6mm rhino boards and rhino gypsum ceiling boards and cornices	m2	63.14		
5.4	Floor tilling (600x600mm ceramic tiles)	m2	63.14		
	<b>Total Carried to summary</b>				
Item	Description	Unit	Qty	Rate (N\$)	Amount (N\$)
6	<b>STEEL WINDOWS &amp; DOORS</b>				
6.1	ND11F	No	3.00		
6.2	External doors and steel frames (D1)	No	3.00		
6.3	External doors and steel frames (D2)	No	1.00		
	<b>Total Carried to summary</b>				

Item	Description	Unit	Qty	Rate (N\$)	Amount (N\$)
<b>7</b>	<b>ROOF STRUCTURAL STEELWORK</b>				
7.1	50x50x3.0mm angle iron	m	70.00		
7.2	75X50X20x2.5mm Lipped channel	m	68.00		
	<b>Total Carried to summary</b>				
Item	Description	Unit	Qty	Rate (N\$)	Amount (N\$)
<b>8</b>	<b>ROOF COVERING</b>				
8.1	0.47x6.2m IBR roofing sheets	Item	17.00		
8.2	0.47x4.8m IBR roofing sheets	Item	12.00		
	<b>Total Carried to summary</b>				
Item	Description	Unit	Qty	Rate (N\$)	Amount (N\$)
<b>9</b>	<b>CARPENTRY</b>				
9.1	0.6mm Rhino board ceiling & all fittings	m2	63.14		
9.2	4,42x07mm (4 rows) 9.0mm shatter/hard board vanished racks mounted to the wall	Item	4		
	<b>Total Carried to summary</b>				
Item	Description	Unit	Qty	Rate (N\$)	Amount (N\$)
<b>10</b>	<b>FURNITURE AND FITTINGS</b>				
10.1	Como Medium Back Operator Chair; Black mesh backrest; Black frame; Black upholstery seat; Rotating Arms with padded armrest; Swivel and tilt mechanism; Black steel 5-Star black castor base; 120 kg weight limit; 5 years guarantee	Item	3.00		
10.2	Blink Visitors Chair; Black epoxy sleight frame; Black mesh backrest; 120 kg weight limit; 5 years guarantee	Item	8.00		
10.3	Activity LHS Single Desk Loop Leg and Modesty Panel with Hinged Door Pedenza 1xFiling Draw & 2 x Standard Draw - 38 x 38mm metal loop black leg and linked to a hinged door Pedenza comprising 1x Lockable Cupboard with Adjustable Shelf, 1x Deep Filer Drawer & 2x Standard Drawers (Central Locking). Silver Handles. 2x Cable Outlets. 16mm Modesty Panel. 22mm Tops with 2x Steel Cross Beams. (Main Desk 900 x 1800) (Hinged Door Pedenza 900 x 500)	Item	3.00		

10.4	Round 4 seater conference table; 1200 Diameter; X-base	Item	1.00		
	<b>Total Carried to summary</b>				
Item	Description	Unit	Qty	Rate (N\$)	Amount (N\$)
11	<b>INTERLOCKING AND STORMWATER WORKS</b>				
11.1	80 mm thick 35 Mpa concrete interlocking grey paving on 20mm (uncompacted thicknes) clean river sand	m2	79.98		
11.2	Offcut to 300mm and backfill in compacted layers not exceeding 150mm to prepare bedding	m3	11.25		
11.3	Construct 400mm wide stormwater channel with metal grid on top(extension to existing stormwater channel), supply and intall two 160mm PVC pipes under proposed building to allow for stormwater flow	No.	8.90		
11.4	re-rooting of existing 50mm (16.8m) water pipe:(see drawing for design and specifications)	sum	16.80		
	<b>Total Carried to summary</b>				
Item	Description	Unit	Qty	Rate (N\$)	Amount (N\$)
12	<b>AIRCONS SUPPLY AND INSTALLATION</b>				
12.1	Complete supply and Installation of a GREE 30000 BTU/hr. Air Conditioner, wall mount	Item	1		
12.2	Complete supply and Installation of a GREE 18000 BTU/hr. Air Conditioner, wall mount	Item	5		
	<b>Total Carried to summary</b>				
Item	Description	Unit	Qty	Rate (N\$)	Amount (N\$)
13	<b>ELECTRICAL INSTALLATION</b>				
13.1	supply and complete electrical installation in accordance to the codes of practices	per office	3.00		
	<b>Total Carried to summary</b>				

No	DESCRIPTION	AMOUNT
1	PRELIMINARY AND GENERALS	
2	EXCAVATION WORKS, FILLING & SOIL POISONING	
3	CONCRETE WORKS	



4	BRICKWORKS, PLASTERING AND WATERPROOFING	
5	PAINT AND TILLING WORKS	
6	STEEL WINDOWS & DOORS	
7	ROOF STRUCTURAL STEEL WORKS	
8	ROOF COVERING	
9	CARPENTRY	
10	FURNITURE AND FITTINGS	
11	INTERLOCKING AND STORMWATER WORKS	
12	AIRCONS SUPPLY AND INSTALLATION	
13	ELECTRICAL INTALLATION	
SUBTOTAL		
CONTIGENCIES 10%		
VAT 15%		
SUB TOTAL		



**Priced Activity Schedule Authorised By:**



Name:		Signature:	
Position:		Date:	
Authorised for and on behalf of:	Company		

## SECTION V: SPECIFICATIONS AND COMPLIANCE SHEET

Procurement Reference Number: \_\_\_\_\_

*[Bidders should complete columns C and D with the specifications and performance of the Works offered. Also state “comply” or “not comply” and give details of any non-compliance/deviation to the specifications required. Attach detailed technical literature if required. Authorise the specifications offered in the signature block below]*

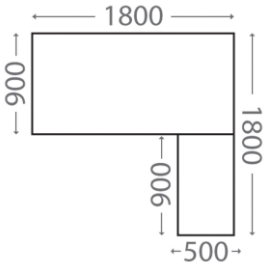
Item No	Specifications and Performance Required	Compliance of Specifications and Performance Offered	Details of Non-Compliance/ Deviation (if applicable)
A*	B*	C	D
<b>1-9 &amp; 11-13</b>	As per Section IV: Price Activity Schedule		
<b>10.1</b>	<p>Como Medium Back Operator Chair; Black mesh backrest; Black frame; Black upholstery seat; Rotating Arms with padded armrest; Swivel and tilt mechanism; Black steel 5-Star black castor base; 120 kg weight limit; 5 years guarantee</p> 		
<b>10.2</b>	<p>Blink Visitors Chair; Black epoxy sleight frame; Black mesh backrest; 120 kg weight limit; 5 years guarantee</p> 		

Item No	Specifications and Performance Required	Compliance of Specifications and Performance Offered	Details of Non-Compliance/ Deviation (if applicable)
<i>A*</i>	<i>B*</i>	<i>C</i>	<i>D</i>
10.3	<p>Activity LHS Single Desk Loop Leg and Modesty Panel with Hinged Door Pedestal 1x Filing Draw &amp; 2 x Standard Draw - 38 x 38mm metal loop black leg and linked to a hinged door Pedestal comprising 1x Lockable Cupboard with Adjustable Shelf, 1x Deep Filer Drawer &amp; 2x Standard Drawers (Central Locking). Silver Handles. 2x Cable Outlets. 16mm Modesty Panel. 22mm Tops with 2x Steel Cross Beams. (Main Desk 900 x 1800) (Hinged Door Pedestal 900 x 500)</p>   <p>© INNOVOCOM (PTY) LTD</p>		
10.4	<p>Round 4 seater conference table; 1200 Diameter; X-base</p> 		

**Specifications and Compliance Sheet Authorised By:**

Name:		Signature:	
Position:		Date:	
Authorised for and on behalf of:		Company	

## SECTION VI: GENERAL CONDITIONS OF CONTRACT AND CONTRACT AGREEMENT

Any resulting contract shall be placed by means of a Purchase Order/Letter of Acceptance and shall be subject to the General Conditions of Contract (GCC) for the Procurement of Goods (Ref. **W/RFQ-GCC**) available on the website of the Public Entity [www.tsumebmun.org.na](http://www.tsumebmun.org.na) except where modified by the Special Conditions below

## SECTION VIII SPECIAL CONDITIONS OF CONTRACT

Procurement Reference Number: \_\_\_\_\_

The clause numbers given in the first column correspond to the relevant clause number of the General Conditions of Contract.

GCC Clause Reference	Special Conditions
<b>Employer GCC 1.1(r)</b>	<i>Tsumeb Municipality</i>
<b>Intended Completion Date GCC</b>	The intended completion date is: 2 months upon receipt of the Award letter/Purchase Order
<b>Project Manager GCC 1.1(y)</b>	The Project Manager is: Mr. E. Erastus
<b>Site GCC 1.1(aa)</b>	The Site is located at the Tsumeb Municipality, Head Office building
<b>Start Date GCC 1.1(dd)</b>	The Start Date shall be: Upon Contract Signing
<b>The Works GCC 1.1(hh)</b>	The Works consist of: The construction of 3 additional offices at the Tsumeb Municipality Head Office Building
<b>Interpretation GCC 2.2</b>	The project will be completed in the following sections:
<b>Interpretation GCC2.3</b>	The following additional documents shall form part of the contract:  - Attached Drawings
<b>Language and Law GCC 3.1</b>	The language of the contract is English  The law that applies to the Contract is the law of Namibia.
<b>Project</b>	The Project Manager shall obtain specific approval from the Employer

GCC Clause Reference	Special Conditions
<b>Manager's Decisions 4.1</b>	before carrying out any of his duties under the Contract which in the Project Manager's opinion will cause the amount finally due under the Contract to exceed the Contract Price or will give entitlement to extension of time. This requirement shall be waived in an emergency affecting safety of personnel or the Works or adjacent property.
<b>Delegation GCC 5.1</b>	The Project Manager <i>may</i> delegate his/her duties.
<b>Notices GCC 6</b>	<p>Any notice shall be sent to the following addresses:</p> <p>For the Employer, the address shall be as given on the page 2 of this Bidding Document and the contact name shall be Mr. Toivo Shipanga</p> <p>For the Contractor, the address shall be as given on the first page of the Purchase Order/Letter of Acceptance and the contact name shall be _____</p>
<b>Insurance GCC 13.1</b>	<p>Except for the cover mentioned in (d)(i) hereunder, the other insurance covers shall be in the joint names of the Contractor and the Employer and the minimum insurance amounts shall be:</p> <ul style="list-style-type: none"> <li>(a) for the Works, Plant and Materials: <i>(for the full amount of the works including removal of debris, professional fee etc...)</i></li> <li>(b) for loss or damage to Equipment: <i>(for the replacement value of the equipment that the contractor intends to use on site until the taking over by the Employer.</i></li> <li>(c) for loss or damage to property (except the Works, Plant, Materials, and Equipment) in connection with Contract <i>for an amount representing the value of the properties that are exposed to the action of the contractor in the execution of the works. It will extend to the property of the Procuring Entity as well).</i></li> <li>(d) for personal injury or death: <ul style="list-style-type: none"> <li>(i) of the Contractor's employees: <i>[The Contractor shall take an adequate insurance cover for its employees for any claim arising in the execution of the works].</i></li> <li>(ii) of other people: <i>[This cover shall be for an adequate amount for Third Party extended to the Employer and its representatives].</i></li> </ul> </li> <li>(e) for loss or damage to materials on-site and for which payment have been included in the Interim Payment</li> </ul>

GCC Clause Reference	Special Conditions
	<p>Certificate, where applicable.</p> <p>The Contractor shall choose to take the insurance covers indicated above as separate covers or a combination of the Contractor's All Risks coupled with the Employer's liability and First Loss Burglary, after approval of the Employer. All insurance covers shall be of nil or the minimum possible deductibles at sole expense of the contractor.</p>
<b>Site Date</b> <b>GCC 14.1</b>	The site Data shall be:
<b>Possession of the Site</b> <b>GCC 20.1</b>	The Site Possession Date shall be: 7 days upon appointment
<b>Procedure for Disputes</b> <b>GCC 24</b>	No Adjudicator shall be appointed under the contract and arbitration shall not apply. If any dispute arises between the Employer and the Contractor in connection with or arising out of the Contract, the parties shall seek to resolve any such dispute by amicable agreement. If the parties fail to resolve such dispute by amicable agreement, within 14 days after one party has notified the other in writing of the dispute, then the dispute shall be referred to court by either party.
<b>Program</b> <b>GCC 25.1</b>	The Contractor shall submit for approval a Program for the Works within 2 days from the date of the Letter of Acceptance or issue of Purchase Order Agreement.
<b>GCC 25.3</b>	Program updates <i>shall</i> be required.
<b>Defects Liability Period</b> <b>GCC 33.1</b>	The Defects Liability Period is: <i>12 Months</i>
<b>Payment Certificates</b> <b>GCC 39.7</b>	“ A single statement of the estimated value of the work executed shall be submitted on completion of the Works. The Project Manager shall check the statement and certify the amount to be paid to the Contractor”.
<b>Payments</b> <b>GCC 40</b>	<p>The amount certified by the Project Manager shall be paid in full within 30 days of receipt by the Employer of an invoice, supported by:</p> <ul style="list-style-type: none"> <li>(a) the payment certificate; and</li> <li>(b) a certificate of Completion of the Works.</li> </ul>
<b>Price Adjustment</b> <b>GCC 44.</b>	The Contract <i>is not</i> subject to price adjustment.
<b>Retention</b> <b>GCC 45.</b>	(i) no proportion of any payments shall be retained
<b>Liquidated Damages</b>	The liquidated damages for the whole of the Works are <i>0.05%</i> per day.

GCC Clause Reference	Special Conditions
<b>GCC 46.1</b>	The maximum amount of liquidated damages for the whole of the Works is 5%
<b>Bonus GCC 47.1</b>	The rate for the Bonus per calendar day is: <i>Not Applicable</i>
<b>Advance Payment GCC 48.1</b>	(i) No advance payment shall be made
<b>Performance Security GCC 49.1</b>	(i) No Performance Security is required
<b>GCC 56.1</b>	“As built” drawings or operating and maintenance manuals <i>are not</i> required.



**SCHEDULE 2****QUOTATION CHECKLIST SCHEDULE****Procurement Reference No.:** \_\_\_\_\_

<b>Description</b>	<b>Attached</b>	<b>Not Attached</b>
Quotation letter		
Priced Activity Schedules		
Specification and Compliance Sheet		
Bid Securing Declaration		
All eligibility requirements as stipulated in the bidding document		

**Disclaimer:** The list defined above is meant to assist the Bidder in submitting the relevant documents and shall not be a ground for the bidder to justify its non-submission of major documents for its quotation to be responsive. The onus remains on the Bidder to ascertain that it has submitted all the documents that have been requested and are needed for its submission to be complete and responsive.

GENERAL NOTES:

- ALL WORK TO BE IN ACCORDANCE WITH THE NATIONAL BUILDING REGULATIONS SABS 0400 – 1990 AND TO COMPLY TO THE LOCAL AUTHORITIES BY-LAWS AND SUB – REGULATIONS.
- ALL STRUCTURAL STEEL, CONCRETE AND TIMBER WORK / ELEMENTS AS PER PROFESSIONAL STRUCTURAL ENGINEERS DETAILS AND SPECIFICATIONS.
- ALL EXTERNAL FINISHES TO WMLC SATISFACTION !!!
- FOR EXPANSION JOINTS IN BRICKWORK REFER TO STRUCTURAL ENGINEERS, DETAIL DRAWINGS AND SPECIFICATION.
- ALL DIMENSIONS AND LEVELS TO BE CHECKED ON SITE.
- LIGHTING AND VENTILATION TO COMPLY WITH N.B.R. PART 'D'.
- WINDOWS AREAS TO BE 10% OF FLOOR AREA AND TO BE 50% OPENABLE.
- DPC'S UNDER WINDOWS AND CHANGES OF FLOOR LEVEL.
- DPM UNDER ALL FLOORS
- ALL NEW WORK TO MATCH EXISTING
- FOUNDATION EXCAVATION MUST BE MIN:100mm BELOW GROUND LEVEL.
- DO NOT SCALE DRAWINGS, USE FIGURED DIMENSIONS.

- DRAINAGE NOTES
- ALL DRAINAGE ON SITE TO COMPLY WITH N.B.R.
  - DRAINAGE AND FIRE HOSE INSTALLATION TO BE DESIGNED AND SUPPLIED BY REGISTERED PLUMBING (SUB-) CONTRACTOR.
  - ALL WASTE FITTINGS TO HAVE RESEAL TRAPS.
  - ALL WASTE PIPES TO BE ACCESSIBLE FOR CLEANING AND REPAIRS.
  - IE'S TO ALL BENDS AND JUNCTIONS.
  - ALL BENDS TO JUNCTIONS TO DRAINS TO BE FITTED WITH RE'S WITH MARKED COVERS AT GROUND LEVEL.
  - EVERY SOIL OR WASTE PIPE EXCEEDING 6m IN LENGTH FROM IT'S JUNCTION WITH A VENTILATION SP OR WP TO BE VENTED UPWARDS.
  - ANY DRAIN PIPES UNDER BUILDING TO BE PROTECTED AGAINST THE LOAD AS PER SABS 0400. (CONC. ENCASED)
  - GULLEYS TO BE MIN OF 2.4m FROM ANY RMP'S.
  - WASTE PIPES TO BE 50 mm dia. GREY/WHITE PVC
  - SOIL PIPE SIZE TO BE 110 mm dia. UNDERGROUND PVC
  - TRAPS TO THE FITTINGS OF ONE-PIPE SYSTEM TO BE FITTED WITH GI 2 VENT VALVES.
  - GRADIENT OF DRAINS TO BE 1:60 FALL (minimum) AND 1:40 FALL (maximum).

STAIR NOTES

- ALL STAIRS TO COMPLY WITH N.B.R.
- RISERS TO BE 200mm (maximum).
- TREADS TO BE 250mm. (minimum)
- LANDINGS TO BE 1000mm (minimum).
- BALUSTRADES TO BE 1000mm IN HEIGHT AND OPENINGS BETWEEN BALUSTRADES TO BE 100mm (maximum).
- HEAD CLEARANCE TO BE 2100mm (minimum)

ROOF CONSTRUCTION NOTES:

- PITCH DEGREE
- ROOF COVER COVER
- RAFTERS SIZE
- TIE BEAMS SIZE
- PURLINS SIZE
- CEILINGS MATERIAL
- 114x38 WALLPLATES.
- GUTTERS AND R.W.D.P. TO BE 100x100mm.
- UNDERLAY – APPROVED WATERPROOF PLASTIC
- BRANDING 38x38 UNLESS A SUSPENDED CEILING IS REQUIRED
- ASBESTOS FASOIA'S
- FLASH HARRY FLASHINGS

FIRE PROTECTION NOTES:

- ALL WORK TO COMPLY WITH ACT 103 (1977) AND SABS 0400 (1990).
- OCCUPANCY CLASSIFICATION: A3
- 30 EXTINGUISHERS TO BE INSTALLED IN ACCORDANCE WITH SABS 0105 (30 x 4.5kg DRY POWDER).
- 17 HOSE REELS TO BE INSTALLED IN ACCORDANCE WITH SABS 543 (1/500m2).
- 8 HYDRANTS TO BE INSTALLED IN ACCORDANCE WITH SABS 1128

- EXISTING FIRE SERVICES TO BE EXTENDED TO NEW HOSE REEL POINTS.
- PORTABLE FIRE EXTINGUISHERS TO BE INSTALLED ON PURPOSE MADE BOARDS AS INDICATED ON PLAN.
- ESCAPE DOORS MAY ONLY BE FITTED WITH APPROVED LOCKING DEVICES (PANIC BAR).
- FLOOR COVERINGS TO BE CLASS: 3 i.e.
  - i. Spread of flame index: 2,1
  - ii. Heat contributed index: 2,1
  - iii. Smoke emitted index: 2,1
  - iv. Surface fire index: 2,1
- EMERGENCY LIGHTING TO BE INSTALLED IN THE:

- ILLUMINATED FIRE ESCAPE SIGNS WITH A MIN. LIGHT INTENSITY OF 50 LUX SHALL BE INSTALLED ABOVE THE ESCAPE DOORS

- PHOTOLUMINESCENT ESCAPE SIGNS TO BE PROVIDED AND TO COMPLY WITH SABS 1186.
- PHOTOLUMINESCENT PICTORIAL SIGNS INDICATING FIRE EQUIPMENT TO BE PROVIDED AND TO COMPLY WITH SABS 1186.
- ROOF VOID SUBDIVIDED WITH NON-COMBUSTIBLE FIRE STOPS INTO AREAS NOT EXCEEDING 300m2, WITH DRY WALL PARTITIONING.
- SUSPENDED CEILINGS AND ITS SUPPORTING MEMBERS SHALL BE OF NON-COMBUSTIBLE MATERIAL.
- STRUCTURAL ELEMENTS AND COMPONENTS SHALL HAVE A MINIMUM STABILITY RATING OF 90 MINUTES.

CONSTRUCTION NOTES

1. WINDOWS AND DOORS TO HAVE PRIESTESS. PRICASTED LINTELS. ALL DOORS AND WINDOWS SHOULD NOT BE BUILT IN BUT INSTALLED INTO OPENINGS BY BUILDER OR MANUFACTURE. FIXING INSTRUCTIONS INCLUDED WITH WINDOWS AND DOORS.
2. DOORS CAN BE COUPLED TO SIDELIGHTS OR OTHER STANDARD ALUMINUM PRODUCTS.
3. ALL WALLS SHOULD BE PLASTERED AND PAINTED AS INDICATED ON SECTIONS OR ELEVATIONS WITH UPVC PAINT.
4. BRICKFORCE SHOULD BE PLACED AFTER EVERY 3RD BRICK COURSE
5. GYPSUM INDUSTRIES. RHINO BOARD. CEILING TO BE FIXED TO A 50X38MM BANTERING AT A 500MM C/C WITH CLOUT NAILS AT 200MM C/C. SKIMMED AND PAINTED TO SPECS.
6. 100MM CONCRETE FOUNDATION SURFACE BED ON 250 MICRON DPM ON WELL COMPACT FILL
7. ALL FOUNDATION TO BE 700X250MM FOR THE 220MM WALLS AND 400X250MM FOR THE 110MM WALLS AT A 400MM DEPTH FROM NATURAL GROUND LEVEL.

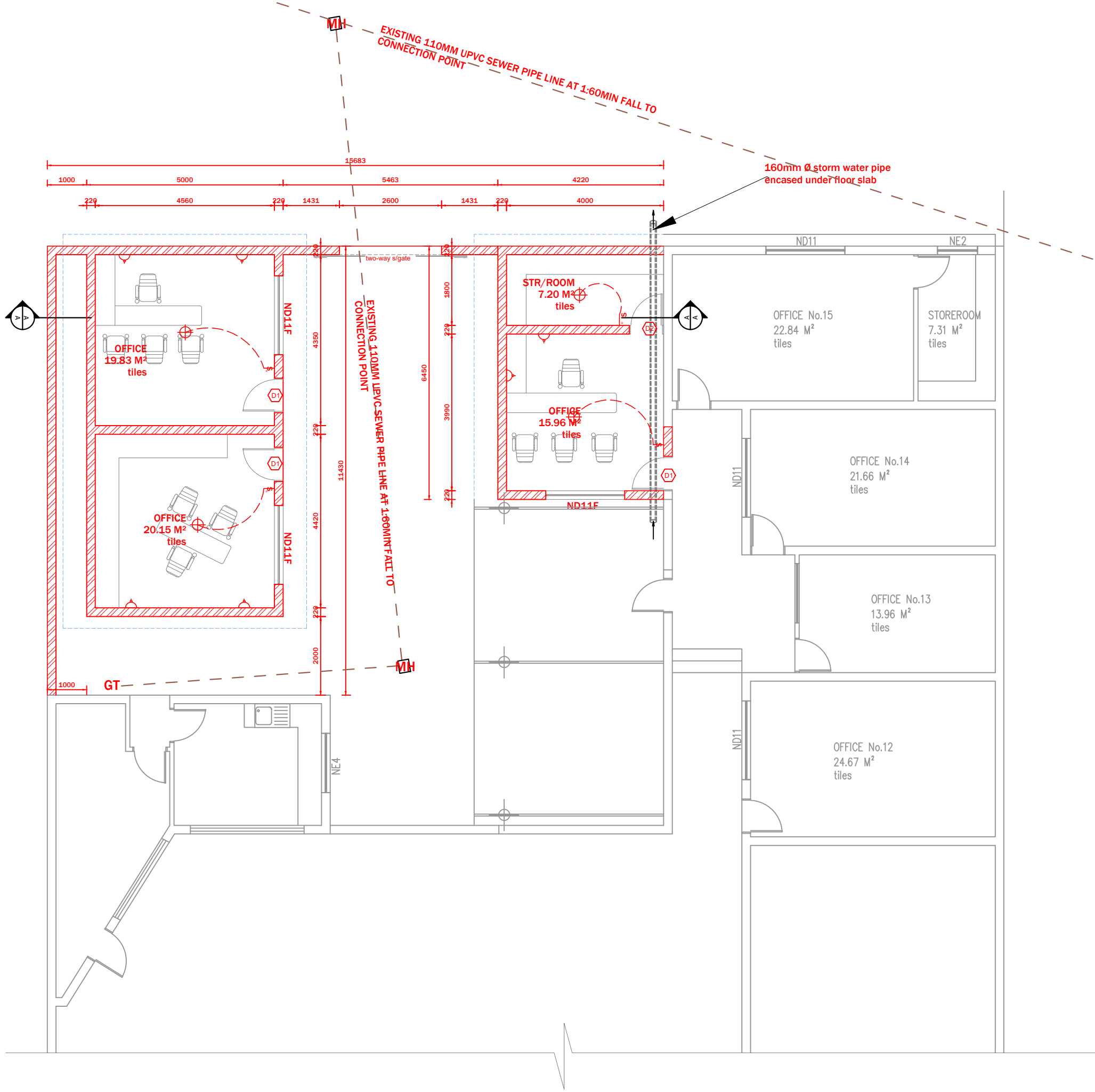

FLOOR PLAN  
scale 1:100

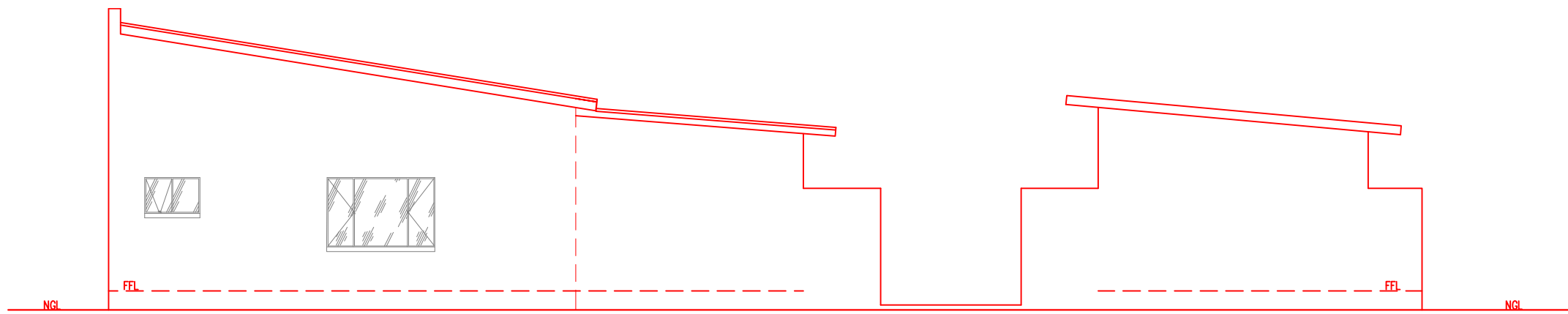

FRONT ELEVATION  
scale 1:100

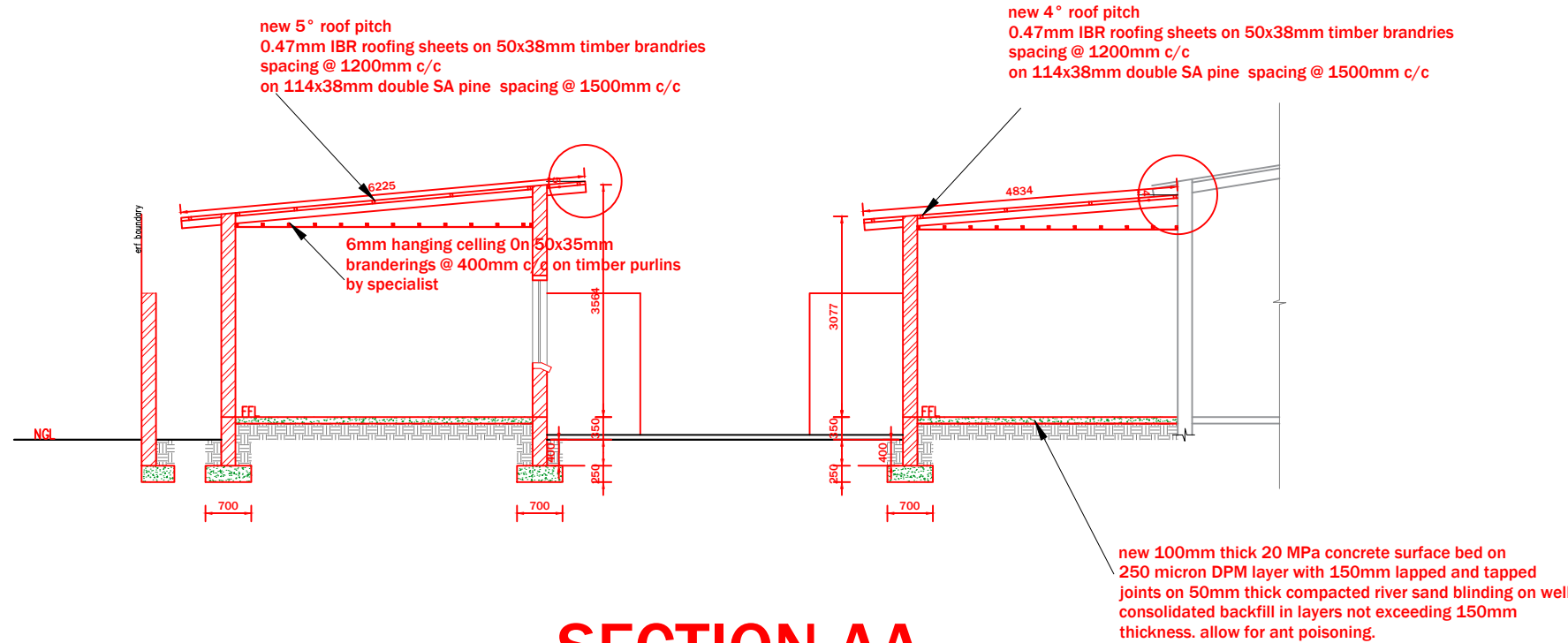

SECTION AA  
scale 1:100

WINDOW SCHEDULE

NO.	WINDOW SIZE	CODE	COUNT
W1	1500mm X 1200mm	ND11F	X3
W2	600mm X 900mm	PT69	X2
W3	900mm X 900mm	PT99	X1
W4	120mm X 900mm	PT129	X1
W5	1500mm X 1800mm	PT1518	X1
W6*	1800mm X 900mm	PT189	X1

DOOR SCHEDULE

NO.	DOOR SIZE	NAME/TYPE	COUNT
D1	1500mm X 2100mm	ENTRANCE DOOR	X1
D2	900mm X 2100mm	S/ FLUSH DOOR	X6
D3	900mm X 2100mm	BACK DOOR	X1
D4	900mm X 2100mm	D/ FLUSH DOOR	X1
D5	900mm X 2100mm	S/ FIRE PROOF DOOR	X1
D6	2500mm X 2100mm	S/ GARAGE DOOR	X1
D7	1800mm X 2100mm	SLIDING DOOR	X1

NOTES:

WINDOWS AND DOORS TO HAVE PRIESTESS. PRICASTED LINTELS. ALL DOORS AND WINDOWS SHOULD NOT BE BUILT IN BUT INSTALLED INTO OPENINGS BY BUILDER OR MANUFACTURE. FIXING INSTRUCTIONS INCLUDED WITH WINDOWS AND DOORS.

ELECTRICAL SYMBOLS

	RECESSED CEILING LIGHTING OUTLET
	15 AMPERE 1 WAY 'LEVER SWITCH'
	DOUBLE 15 AMPERE PLUG
	SINGLE 15 AMPERE PLUG
	EXTERNAL WALL LIGHT OUTLET
	DOUBLE FLORESCENT LIGHTS
	DISTRIBUTION BOARD
	PRE- PAID METER BOARD
	STOVE PLUG 15 AMPERE
	15 AMPERE 2 WAY 'LEVER SWITCH'

SUMMARY OF AREAS

OFFICIAL STAMPS

CLIENT:

MUNICIPALITY OF TSUMEB  
P/BAG 2012  
067 221056  
Tsumeb

PROJECT:

PROPOSED EXTENSION ON ERF 264/ 62  
MOSES GAROEB STREET  
TSUMEB

SCALE:

AS SHOWN

DATE:

JULY 2024

REVISION



TSUMEB MUNICIPALITY  
P/BAG 2012, TSUMEB  
TEL: +264 67 221 056  
FAX: +264 67 221 404

GENERAL NOTES:

- ALL WORK TO BE IN ACCORDANCE WITH THE NATIONAL BUILDING REGULATIONS SABS 0400 – 1990 AND TO COMPLY TO THE LOCAL AUTHORITIES BY-LAWS AND SUB – REGULATIONS.
- ALL STRUCTURAL STEEL, CONCRETE AND TIMBER WORK / ELEMENTS AS PER PROFESSIONAL STRUCTURAL ENGINEERS DETAILS AND SPECIFICATIONS.
- ALL EXTERNAL FINISHES TO WMLC SATISFACTION !!!
- FOR EXPANSION JOINTS IN BRICKWORK REFER TO STRUCTURAL ENGINEERS, DETAIL DRAWINGS AND SPECIFICATION.
- ALL DIMENSIONS AND LEVELS TO BE CHECKED ON SITE.
- LIGHTING AND VENTILATION TO COMPLY WITH N.B.R. PART 'D'.
- WINDOWS AREAS TO BE 10% OF FLOOR AREA AND TO BE 50% OPENABLE.
- DPC'S UNDER WINDOWS AND CHANGES OF FLOOR LEVEL.
- DPM UNDER ALL FLOORS
- ALL NEW WORK TO MATCH EXISTING
- FOUNDATION EXCAVATION MUST BE MIN:100mm BELOW GROUND LEVEL.
- DO NOT SCALE DRAWINGS, USE FIGURED DIMENSIONS.

DRAINAGE NOTES

- ALL DRAINAGE ON SITE TO COMPLY WITH N.B.R.
- DRAINAGE AND FIRE HOSE INSTALLATION TO BE DESIGNED AND SUPPLIED BY REGISTERED PLUMBING (SUB-) CONTRACTOR.
- ALL WASTE FITTINGS TO HAVE RESEAL TRAPS.
- ALL WASTE PIPES TO BE ACCESSIBLE FOR CLEANING AND REPAIRS.
- IE'S TO ALL BENDS AND JUNCTIONS.
- ALL BENDS TO JUNCTIONS TO DRAINS TO BE FITTED WITH RE'S WITH MARKED COVERS AT GROUND LEVEL.
- EVERY SOIL OR WASTE PIPE EXCEEDING 6m IN LENGTH FROM IT'S JUNCTION WITH A VENTILATION SP OR WP TO BE VENTED UPWARDS.
- ANY DRAIN PIPES UNDER BUILDING TO BE PROTECTED AGAINST THE LOAD AS PER SABS 0400. (CONC. ENCASED)
- GULLEY'S TO BE MIN OF 2.4m FROM ANY RMP'S.
- WASTE PIPES TO BE 50 mm dia. GREY/WHITE PVC
- SOIL PIPE SIZE TO BE 110 mm dia. UNDERGROUND PVC
- TRAPS TO THE FITTINGS OF ONE-PIPE SYSTEM TO BE FITTED WITH GI 2 VENT VALVES.
- GRADIENT OF DRAINS TO BE 1:60 FALL (minimum) AND 1:40 FALL (maximum).

STAIR NOTES

- ALL STAIRS TO COMPLY WITH N.B.R.
- RISERS TO BE 200mm (maximum).
- TREADS TO BE 250mm. (minimum)
- LANDINGS TO BE 1000mm (minimum).
- BALUSTRADES TO BE 1000mm IN HEIGHT AND OPENINGS BETWEEN BALUSTRADES TO BE 100mm (maximum).
- HEAD CLEARANCE TO BE 2100mm (minimum)

ROOF CONSTRUCTION NOTES:

- PITCH DEGREE
- ROOF COVER COVER
- RAFTERS SIZE
- TIE BEAMS SIZE
- PURLINS SIZE
- CEILINGS MATERIAL
- 114x38 WALLPLATES.
- GUTTERS AND R.W.D.P. TO BE 100x100mm.
- UNDERLAY – APPROVED WATERPROOF PLASTIC
- BRANDING 38x38 UNLESS A SUSPENDED CEILING IS REQUIRED
- ASBESTOS FLASHINGS
- FLASH HARRY FLASHINGS

FIRE PROTECTION NOTES:

- ALL WORK TO COMPLY WITH ACT 103 (1977) AND SABS 0400 (1990).
- OCCUPANCY CLASSIFICATION: A3
- 30 EXTINGUISHERS TO BE INSTALLED IN ACCORDANCE WITH SABS 0105 (30 x 4,5kg DRY POWDER).
- 17 HOSE REELS TO BE INSTALLED IN ACCORDANCE WITH SABS 543 (1/500m2).
- 8 HYDRANTS TO BE INSTALLED IN ACCORDANCE WITH SABS 1128

- EXISTING FIRE SERVICES TO BE EXTENDED TO NEW HOSE REEL POINTS.
- PORTABLE FIRE EXTINGUISHERS TO BE INSTALLED ON PURPOSE MADE BOARDS AS INDICATED ON PLAN.
- ESCAPE DOORS MAY ONLY BE FITTED WITH APPROVED LOCKING DEVICES (PANIC BAR).
- FLOOR COVERINGS TO BE CLASS: 3 i.e.
  - i. Spread of flame index: 2,1
  - ii. Heat contributed index: 2,1
  - iii. Smoke emitted index: 2,1
  - iv. Surface fire index: 2,1
- EMERGENCY LIGHTING TO BE INSTALLED IN THE:

- ILLUMINATED FIRE ESCAPE SIGNS WITH A MIN. LIGHT INTENSITY OF 50 LUX SHALL BE INSTALLED ABOVE THE ESCAPE DOORS

- PHOTOLUMINESCENT ESCAPE SIGNS TO BE PROVIDED AND TO COMPLY WITH SABS 1186.
- PHOTOLUMINESCENT PICTORIAL SIGNS INDICATING FIRE EQUIPMENT TO BE PROVIDED AND TO COMPLY WITH SABS 1186.
- ROOF VOID SUBDIVIDED WITH NON-COMBUSTIBLE FIRE STOPS INTO AREAS NOT EXCEEDING 300m2, WITH DRY WALL PARTITIONING.
- SUSPENDED CEILINGS AND ITS SUPPORTING MEMBERS SHALL BE OF NON-COMBUSTIBLE MATERIAL.
- STRUCTURAL ELEMENTS AND COMPONENTS SHALL HAVE A MINIMUM STABILITY RATING OF 90 MINUTES.

NOMINAL DIAMETER	DEPTH OF BLOCK D(mm)	MAXIMUM TESTING PRESSURE	
		1350 kPa	X(mm)
600	1400	2160	
500	1400	1810	
400	1200	1460	
315	1200	1200	
200	800	760	
160	640	630	
110	440	440	
90	360	360	
63	252	252	
50	252	252	

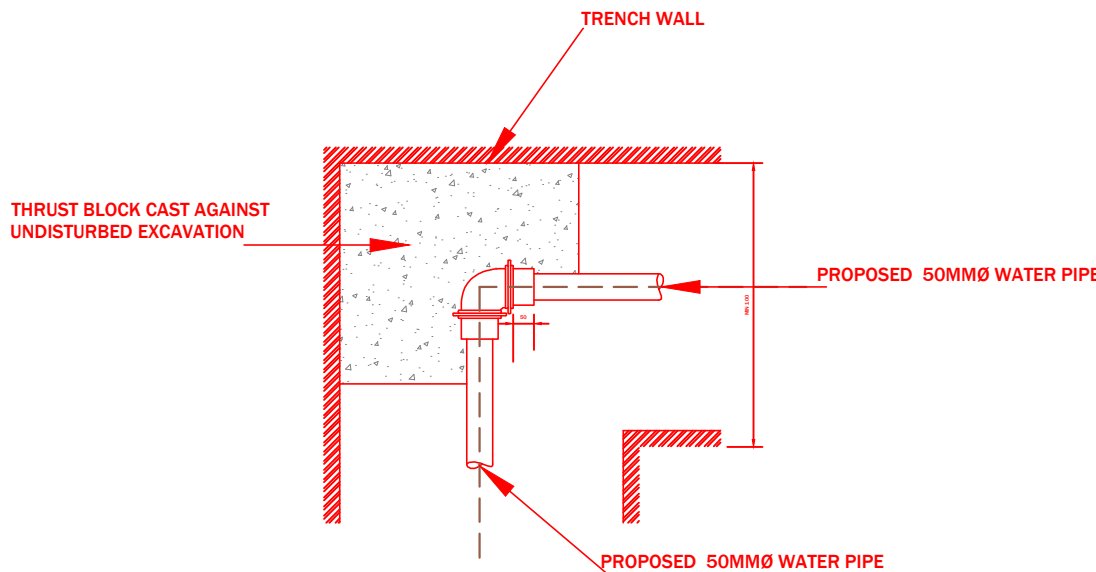

PLAN VIEW OF THRUST BLOCK DETAIL W NTS

NOMINAL DIAMETER	DEPTH OF BLOCK D(mm)	MAXIMUM TESTING PRESSURE	
		1350 kPa	X(mm)
600	1400	410	
500	1400	390	
400	1200	370	
315	1200	352	
200	800	250	
160	640	210	
110	440	120	
90	360	100	
63	252	100	
50	252	252	

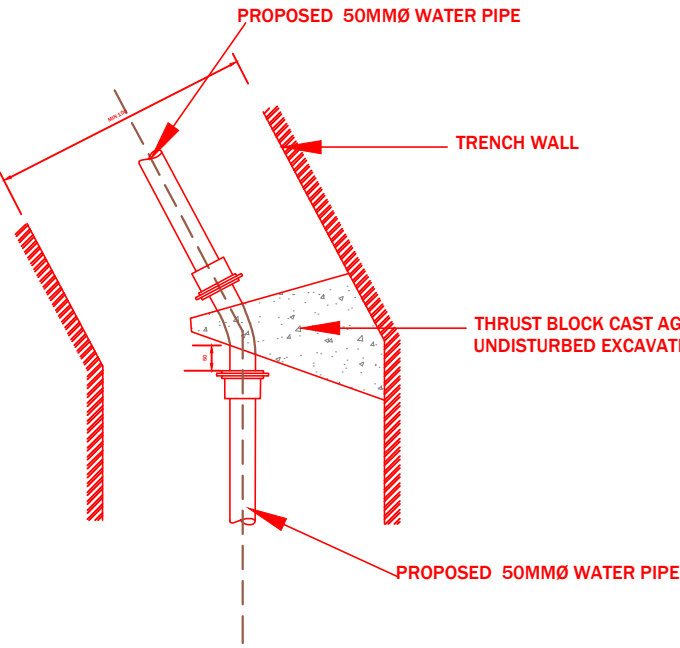

PLAN VIEW OF THRUST BLOCK DETAIL Z NTS

NOMINAL DIAMETER	DEPTH OF BLOCK D(mm)	MAXIMUM TESTING PRESSURE	
		1350 kPa	X(mm)
600	1400	2160	
500	1400	1810	
400	1200	1460	
315	1200	1200	
200	800	760	
160	640	630	
110	440	440	
90	360	360	
63	252	252	
50	252	252	

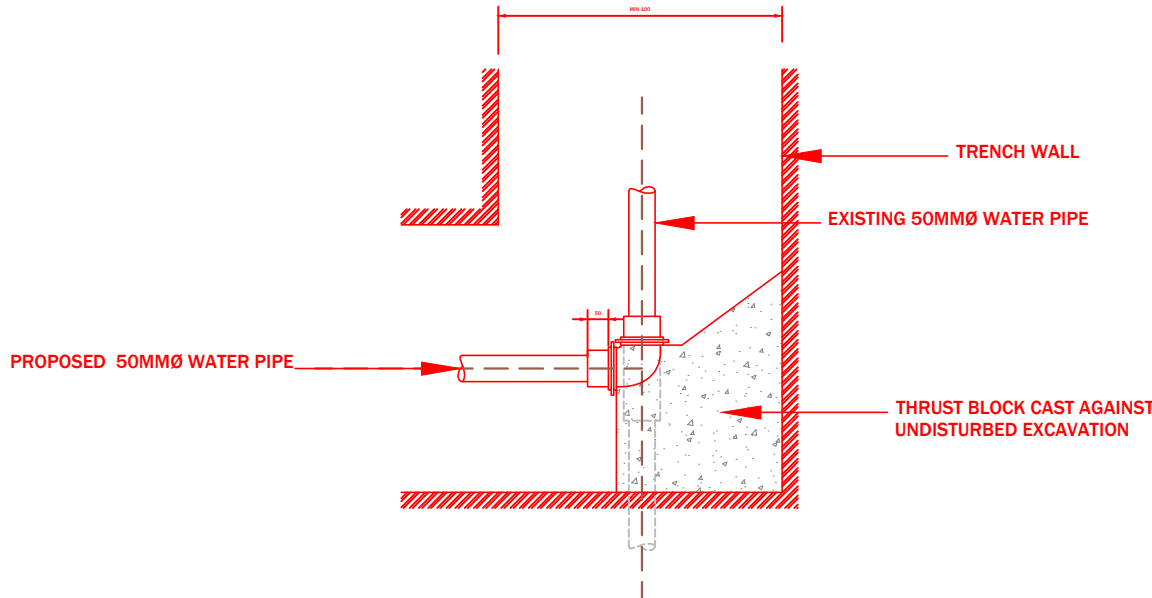

PLAN VIEW OF THRUST BLOCK DETAIL X NTS

PRESSURE TESTING NOTE

1. THE TABLES ARE VALID FOR 100 KPA EARTH BEARING PRESSURE
2. X-DIMENSIONS MAY BE REDUCED FOR HIGHER EARTH BEARING PRESSURE
3. HALF OF THE DEPTH OF THE BLOCK SHALL BE BELOW THE PIPE AXIS
4. KEEP COUPLINGS AND FLANGES 25MM CLEAR FROM CONCRETE

NOMINAL DIAMETER	DEPTH OF BLOCK D(mm)	MAXIMUM TESTING PRESSURE	
		1350 kPa	X(mm)
600	1400	410	
500	1400	390	
400	1200	370	
315	1200	352	
200	800	250	
160	640	210	
110	440	120	
90	360	100	
63	252	100	
50	252	252	

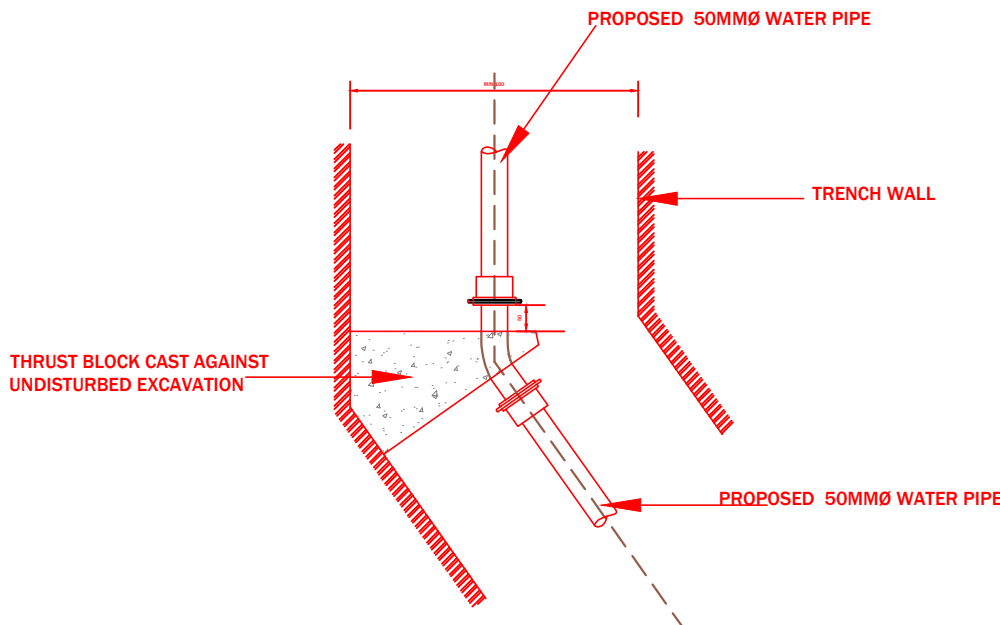

PLAN VIEW OF THRUST BLOCK DETAIL Y NTS

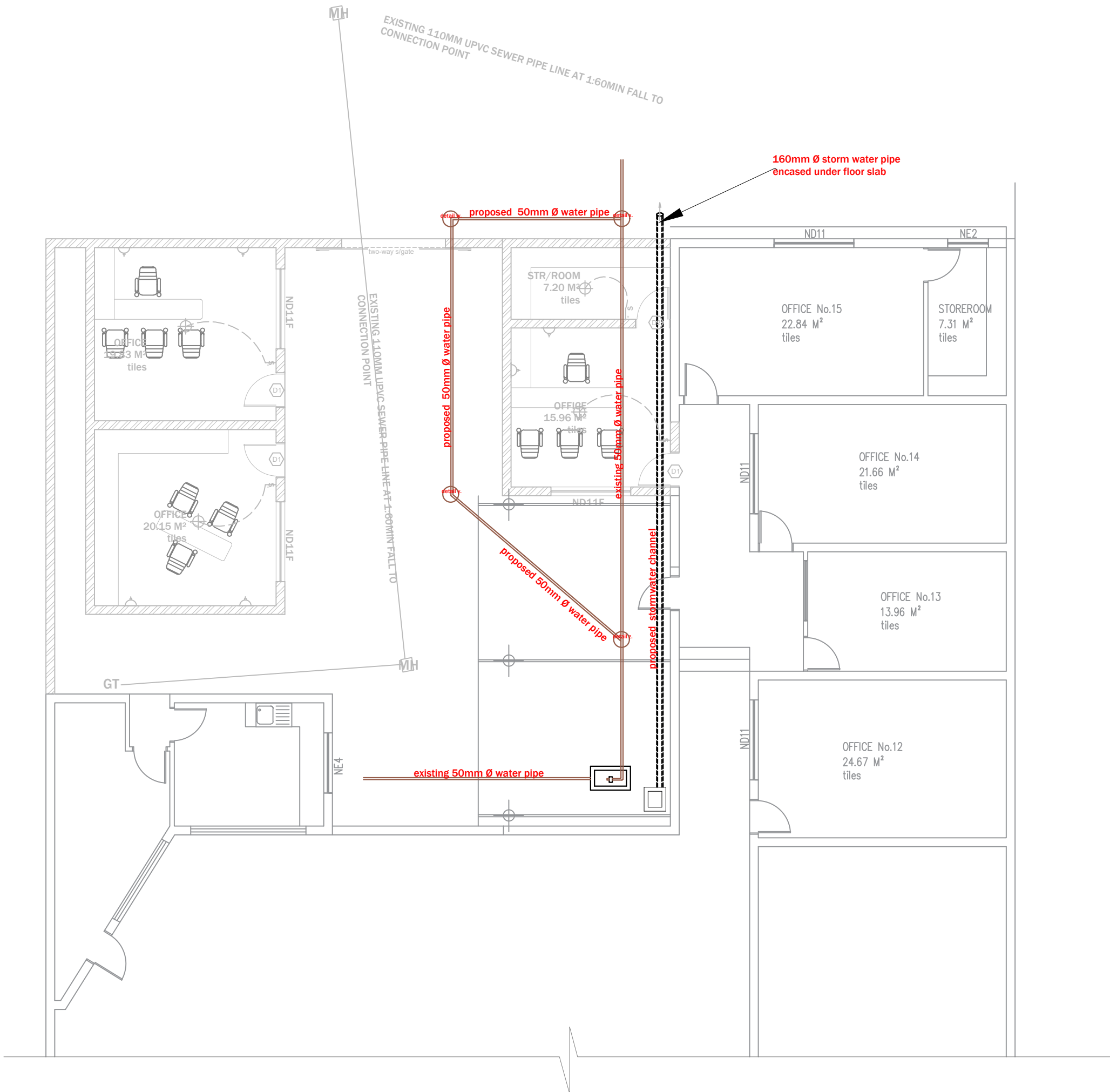

ELECTRICAL SYMBOLS	
	RECESSED CEILING LIGHTING OUTLET
	15 AMPERE 1 WAY 'LEVER SWITCH'
	DOUBLE 15 AMPERE PLUG
	SINGLE 15 AMPERE PLUG
	EXTERNAL WALL LIGHT OUTLET
	DOUBLE FLORESCENT LIGHTS
	DISTRIBUTION BOARD
	PRE- PAID METER BOARD
	STOVE PLUG 15 AMPERE
	15 AMPERE 2 WAY 'LEVER SWITCH'
SUMMARY OF AREAS	
OFFICIAL STAMPS	
<b>CLIENT:</b> MUNICIPALITY OF TSUMEB P/BAG 2012 067 221056 Tsumeb	
<b>PROJECT:</b> RE-ROOTING OF EXISTING WATER LINE ON ERF 264/62 MOSES GAROEB STREET TSUMEB	
<b>SCALE:</b> AS SHOWN	
<b>DATE:</b> JULY 2024	<b>REVISION</b>
<div>TSUMEB MUNICIPALITY P/BAG 2012, TSUMEB TELL: +264 67 221 056 FAX: +264 67 221 404</div>	